

SPECIFICATIONS

SPECIFICATIONS

4.0L ENGINE

DESCRIPTION	SPECIFICATION
Engine Type	In-line 6 Cylinder
Bore and Stroke	98.4 x 86.69 mm (3.88 x 3.413 in.)
Displacement	4.0L (242 cu. in.)
Compression Ratio	8.8:1
Firing Order	1-5-3-6-2-4
Lubrication	Pressure Feed-Full Flow Filtration
Cooling System	Liquid Cooled-Forced Circulation
Cylinder Block	Cast Iron
Crankshaft	Cast Nodular Iron
Cylinder Head	Cast Iron
Camshaft	Cast Iron
Pistons	Aluminum Alloy
Combustion Chamber	Dual-Quench
Connecting Rods	Cast Malleable Iron
CAMSHAFT	
Hydraulic Tappet Clearance	Zero Lash
Bearing Clearance	0.025 to 0.076 mm (0.001 to 0.003 in.)
Bearing Journal Diameter	
No. 1	51.54 to 51.56 mm (2.029 to 2.030 in.)
No. 2	51.28 to 51.31 mm (2.019 to 2.020 in.)
No. 3	51.03 to 51.05 mm (2.009 to 2.010 in.)
No. 4	50.78 to 50.80 mm (1.999 to 2.000 in.)

DESCRIPTION	SPECIFICATION
Base Circle Runout (MAX)	0.03 mm (0.001 in.)
Valve Lift	
Intake	10.350 mm (0.4075 in.)
Exhaust	10.528 mm (0.4145 in.)
Valve Timing	
Intake	
Opens	12.4° BTDC
Closes	60.9° ABDC
Exhaust	
Opens	49.8 BBDC
Closes	29.2° ATDC
Valve Overlap	41.6°
Intake Duration	253.3°
Exhaust Duration	259.°
CRANKSHAFT	
End Play	0.038 to 0.165 mm (0.0015 to 0.0065 in.)
Main Bearing Journal Diameter	
No. 1-6	63.489 to 63.502 mm (2.4996 to 2.5001 in.)
No. 7	63.449 to 63.487 mm (2.4980 to 2.4995 in.)
Main Bearing Journal Width	
No. 1	27.58 to 27.89 mm (1.086 to 1.098 in.)
No. 3	32.28 to 32.33 mm (1.271 to 1.273 in.)
No. 2-4-5-6-7	30.02 to 30.18 mm (1.182 to 1.188 in.)
Main Bearing Clearance	0.03 to 0.06 mm (0.001 to 0.0025 in.)
Preferred	0.051 mm (0.002 in.)

SPECIFICATIONS (Continued)

DESCRIPTION	SPECIFICATION
Connecting Rod Journal Diameter	53.17 to 53.23 mm (2.0934 to 2.0955 in.)
Connecting Rod Journal Width	27.18 to 27.33 mm (1.070 to 1.076 in.)
Out-of-Round (MAX)	0.013 mm (0.0005 in.)
Taper (MAX)	0.013 mm (0.0005 in.)
CYLINDER BLOCK	
Deck Height	240.03 to 240.18 mm (9.450 to 9.456 in.)
Deck Clearance (Below Block)	0.546 mm (0.0215 in.)
Cylinder Bore Diameter Standard	98.45 to 98.48 mm (3.8759 to 3.8775 in.)
Taper	0.025 mm (0.001 in.)
Out-ofRound	0.025 mm (0.001 in.)
Tappet Bore Diameter	23.000 to 23.025 mm (0.9055 to 0.9065 in.)
Flatness	0.03 mm per 25 mm (0.001 in. per 1 in.) 0.05 mm per 152 mm (0.002 in. per 6 in.)
Flatness Max.	0.20 mm max. for total length (0.008 in. max. for total length)
Main Bearing Bore Diameter	68.3514 to 68.3768 mm (2.691 to 2.692 in.)
CONNECTING ROD	
Total Weight (Less Bearing)	663 to 671 grams (23.39 to 23.67 oz.)
Length (Center-to-Center)	155.52 to 155.62 mm (6.123 to 6.127 in.)
Piston Pin Bore Diameter	23.59 to 23.62 mm (0.9288 to 0.9298 in.)

DESCRIPTION	SPECIFICATION
Bore (Less Bearings)	56.08 to 56.09 mm (2.2080 to 2.2085 in.)
Bearing Clearance	0.025 to 0.076 mm (0.001 to 0.003 in.)
Preferred	0.044 to 0.050 mm (0.0015 to 0.0020 in.)
Side Clearance	0.25 to 0.48 mm (0.010 to 0.019 in.)
Twist (Max.)	0.002 mm per mm (0.002 in. per inch)
Bend (Max.)	0.002 mm per mm (0.002 in. per inch.)
CYLINDER COMPRESSION PRESSURE	
Pressure Range	827 to 1,034 kPa (120 to 150 psi)
Max. Variation Between Cylinders	206 kPa (30 psi)
CYLINDER HEAD	
Combustion Chamber	55.22 to 58.22 cc (3.37 to 3.55 cu. in.)
Valve Guide I. D. (Integral)	7.95 to 7.97 mm (0.313 to 0.314 in.)
Valve Stem-to-Guide Clearance	0.025 to 0.076 mm (0.001 to 0.003 in.)
Valve Seat Angle	
Intake	44.5°
Exhaust	44.5°
Valve Seat Width	1.02 to 1.52 mm (0.040 to 0.060 in.)
Valve Seat Runout	0.064 mm (0.0025 in.)
Flatness	0.03 mm per 25 mm (0.001 in. per 1 in.) 0.05 mm per 152 mm (0.002 in. per 6 in.)

SPECIFICATIONS (Continued)

DESCRIPTION	SPECIFICATION
Flatness Max.	0.20 mm - max. for total length (0.008 in. max. for total length)
ROCKER ARMS, PUSH RODS & TAPPETS	
Rocker Arm Ratio	1.6:1
Push Rod Length (Pink)	244.856 to 245.364 mm (9.640 to 9.660 in.)
Push Rod Diameter	7.92 to 8.00 mm (0.312 to 0.315 in.)
Hydraulic Tappet Diameter	22.962 to 22.974 mm (0.904 to 0.9045 in.)
Tappet-to-Bore Clearance	0.025 to 0.063 mm (0.001 to 0.0025 in.)
VALVES	
Valve Length (Overall)	
Intake	122.479 to 122.860 mm (4.822 to 4.837 in.)
Exhaust	122.860 to 123.241 mm (4.837 to 4.852 in.)
Valve Stem Diameter	7.899 to 7.925 mm (0.311 to 0.312 in.)
Stem-to-Guide Clearance	0.025 to 0.076 mm (0.001 to 0.003 in.)
Valve Head Diameter	
Intake	48.387 to 48.641 mm (1.905 to 1.915 in.)
Exhaust	37.973 to 38.227 mm (1.495 to 1.505 in.)
Valve Face Angle	
Intake	46.5°
Exhaust	46.5°
Tip Refinishing (Max. Allowable)	0.25 mm (0.010 in.)

DESCRIPTION	SPECIFICATION
VALVE SPRINGS	
Free Length (Approx.)	47.65 mm (1.876 in.)
Spring Load	
Valve Closed	316 to 351 N @ 41.656 mm (71 to 79 lbf. @ 1.64 in.)
Valve Open	898.6 to 969.7 N @ 30.89 mm (202 to 218 lbf @ 1.216 in.)
Inside Diameter	21.0 mm to 21.51 mm (0.827 to 0.847 in.)
Installed Height	41.656 mm (1.64 in.)
PISTONS	
Weight (Less Pin)	417 to 429 grams (14.7 to 15.1 oz.)
Piston Pin Bore (Centerline to Piston Top)	40.61 to 40.72 mm (1.599 to 1.603 in.)
Piston-to-Bore Clearance	0.018 to 0.038 mm (0.0008 to 0.0015 in.)
Ring Gap Clearance	
Top Compression Ring	0.229 to 0.610 mm (0.0090 to 0.0240 in.)
2nd Compression Ring	0.483 to 0.965 mm (0.0190 to 0.0380 in.)
Oil Control Steel Rails	0.254 to 1.500 mm (0.010 to 0.060 in.)
Ring Side Clearance	
Compression Rings	0.042 to 0.084 mm (0.0017 to 0.0033 in.)
Oil Control Rings	0.06 to 0.21 mm (0.0024 to 0.0083 in.)
Piston Ring Groove Height	
Compression Rings	1.530 to 1.555 mm (0.0602 to 0.0612 in.)
Oil Control Ring	4.035 to 4.060 mm (0.1589 to 0.1598 in.)

SPECIFICATIONS (Continued)

DESCRIPTION	SPECIFICATION
Piston Ring Groove Diameter	
No.1 Compression Ring	88.39 to 88.65 mm (3.48 to 3.49 in.)
No.2 Compression Ring	87.63 to 87.88 mm (3.45 to 3.46 in.)
Oil Control Ring	89.66 to 89.92 mm (3.53 to 3.54 in.)
Piston Pin Bore Diameter	23.650 to 23.658 mm (0.9312 to 0.9315 in.)
Piston Pin Diameter	23.637 to 23.640 mm (0.9306 to 0.9307 in.)
Piston-to-Pin Clearance	0.0102 to 0.0208 mm (0.0005 to 0.0009 in.)
Piston-to-Pin Connecting Rod (Press Fit)	8.9 kN (2000 lbf.)
OIL PUMP	
Gear-to-Body Clearance	0.051 to 0.102 mm
(Radial)	(0.002 to 0.004 in.)
Gear-to-Body Clearance (Radial) Preferred	0.051 mm (0.002 in.)
Gear End Clearance Plastigage	0.051 to 0.152 mm (0.002 to 0.006 in.)
Gear End Clearance Plastigage (Preferred)	0.051 mm (0.002 in.)
Gear End Clearance Feeler Gauge	0.1016 to 0.2032 mm (0.004 to 0.008 in.)
Gear End Clearance Feeler Gauge (Preferred)	0.1778 mm (0.007 in.)
Oil Pressure	
At Idle Speed	89.6 kPa (13 psi)
At 1600 rpm & Higher	255 to 517 kPa (37 to 75 psi)
Oil Pressure Relief	517 kPa (75 psi)

**TORQUE SPECIFICATIONS
4.0L ENGINE**

DESCRIPTION	N·m	Ft. Lbs.	In. Lbs.
A/C Compressor—Bolts	28	—	250
Block Heater—Nut	2	—	16
Camshaft Sprocket—Bolt	68	50	—
Camshaft Thrust Plate to Cylinder Block—Screws	24	18	—
Clutch Cover to Flywheel—Bolts	54	40	—
Coil Bracket to Block—Bolts	22	—	192
Connecting Rod—Nuts	45	33	—
Cylinder Block—Drain Plugs	34	25	—
Cylinder Head—Bolts	135	100	—
Cylinder Head Cover—Bolts	10	—	85
Distributor Clamp—Bolts	23	—	204
Engine Mounts—Front			
Support Bracket Bolts	61	45	—
Support Cushion Bolts/Nuts	41	30	—
Support Cushion Bracket Bolts	54	40	—
Support Cushion Bracket Stud Nuts	41	30	—
Support Cushion Thru-Bolt	65	48	—
Engine Mounts—Rear			
Crossmember to Sill Bolts—(Automatic)	41	30	—
Insulator Stud Assembly—Nut	41	30	—
Support Cushion/Crossmember—Nuts	22	—	192
Support Cushion/Bracket—Nuts (Manual)	75	55	—
Transmission Support Bracket—Bolt (Manual)	46	34	—
Transmission Support Bracket/Cushion—Bolt (4WD Auto)	75	55	—
Transmission Support Adaptor Bracket—Bolts (2WD Auto)	75	55	—
Exhaust Manifold/Pipe—Nuts	27	20	—

SPECIFICATIONS (Continued)

DESCRIPTION	N·m	Ft. Lbs.	In. Lbs.
Intake/Exhaust Manifold			
Fasteners #1-5	33	24	—
Fasteners #6 and 7	14	—	126
Fasteners #8-11	33	24	—
Flywheel to Converter Housing—Bolts	38	28	—
Flywheel to Crankshaft—Bolts	143	105	—
Front Cover to Block—Bolts			
1/4-20	7	—	60
5/16-18	22	—	192
Fuel Rail—Bolts/Stud	12	—	108
Generator—Bolts	57	42	—
Generator Bracket to Engine—Bolts	47	35	—
Idler Pulley to Cylinder Head—Bolt	47	35	—
Main Bearing Cap—Bolts	108	80	—
Oil Filter	18	—	156
Oil Filter Connector to			
Adaptor	47	35	—
Block	68	50	—
Adaptor Bolts	102	50	—
Oil Galley—Plug	41	30	—
Oil Pan—Bolts			
1/4-20	9.5	—	84
5/16-18	15	—	132
Oil Pan—Drain Plug	34	25	—
Oil Pump			
Mounting Bolts	23	—	204
Cover Bolts	8	—	70
Rocker Arm Assembly to Cylinder Head—Capscrews	30	21	—
Spark Plugs	37	27	—
Starter Motor—Mounting Bolts	45	33	—
Thermostat Housing—Bolts	18	—	156
Throttle Body—Bolts	10	—	90
Vibration Damper—Bolt	108	80	—
Water Pump to Block—Bolts	23	17	—

SPECIAL TOOLS

4.0L ENGINE

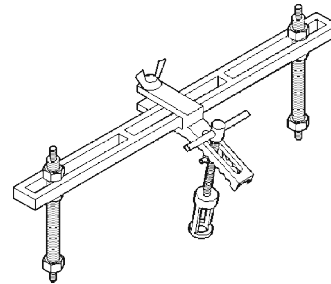

Valve Spring Compressor Tool MD-998772A

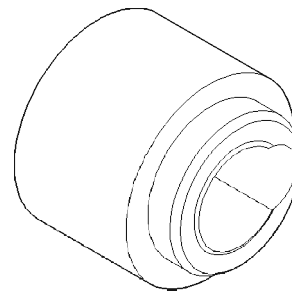

Timing Case Cover Alignment and Seal installation Tool 6139

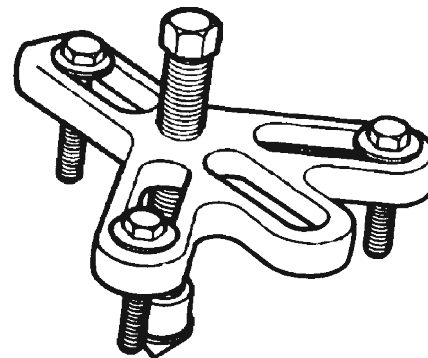

Vibration Damper Removal Tool 7697

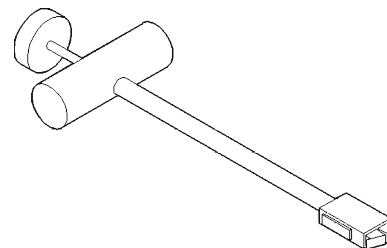

Hydraulic Valve Tappet Removal/Installation Tool C-4129-A

